

The Commons at Georgetown

DuPont Highway, Georgetown, Delaware

Lease/Condo

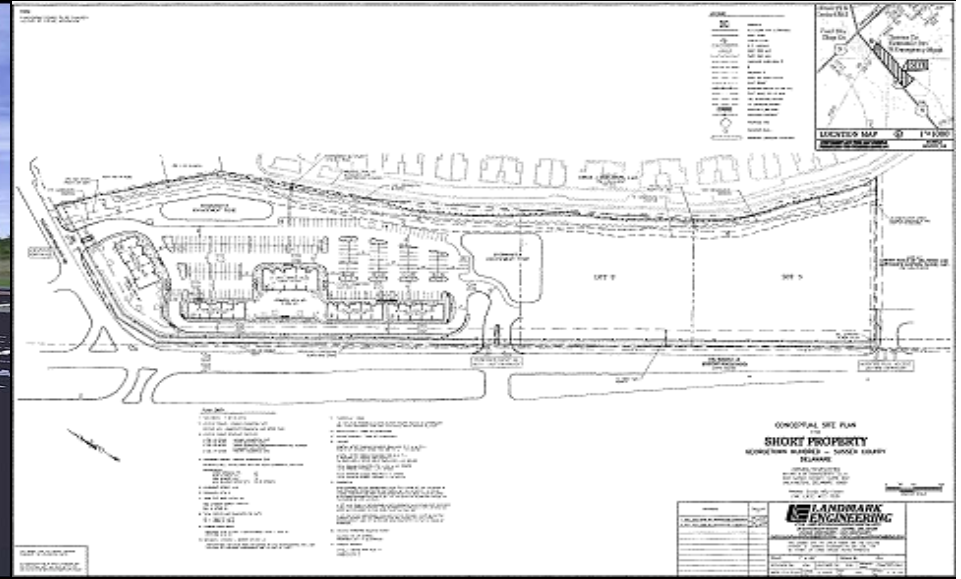

Price

- Lease Rate: Negotiable
- Condo Rate: Negotiable

Available

- Office suites from 1,665sf
- Pad sites of 2.7 acres and 3.1 acres

Building Highlights

- Great highway frontage
- Professional office use
- Ample convenient parking
- Build-to-suit improvements
- New construction

For more information and inspection,
please contact:

**CUSHMAN & WAKEFIELD OF
DELAWARE, INC.**

Ernie Felici, Jr.

Associate

ernie.felici@cushwake.com

John Q. Birmingham, III

Director

john.birmingham@cushwake.com

Phone: (302) 655-9621

Fax: (302) 655-9662

**CONSTRUCTION
UNDERWAY!!!**

A commission computed in accordance with the rates and conditions of our agency agreement with our principal, when received from our principal, will be paid to a cooperating broker who (i) in the case of a lease, consummates a lease which is unconditionally executed and delivered by and between lessor and lessee and (ii) in the case of sale, consummates a closing and transfer of title between our principal and purchaser. (Inquire for rates and additional conditions.)

No warranty or representation, expressed or implied, is made as to the accuracy of the information contained herein, and same is submitted subject to errors omissions, change of price, rental or other conditions, withdrawal without notice, and to any specific listing conditions, imposed by our principals.



**CUSHMAN &
WAKEFIELD**

Global Real Estate SolutionsSM

The Commons at Georgetown

DuPont Highway, Georgetown, Delaware

Lease/Condo



Traffic Count

- 17,699 cars per day (2004)

Demographics*

- 14,134 people in 5 mile radius (2008 est.)
 - Projected 5 year growth rate: 5.66%
- 5,847 households in 5 mile radius (2008 est.)
 - Projected 5 year growth rate: 7.54%

* *Demographics obtained through CoStar*

Distance from Georgetown, DE

- Seaford – 16 miles
- Milford – 16 miles
- Bethany Beach – 18 miles
- Salisbury, MD – 28 miles
- Ocean City, MD – 31 miles
- Baltimore, MD – 101 miles
- Philadelphia, PA – 113 miles

A commission computed in accordance with the rates and conditions of our agency agreement with our principal, when received from our principal, will be paid to a cooperating broker who (i) in the case of a lease, consummates a lease which is unconditionally executed and delivered by and between lessor and lessee and (ii) in the case of sale, consummates a closing and transfer of title between our principal and purchaser. (Inquire for rates and additional conditions.) No warranty or representation, expressed or implied, is made as to the accuracy of the information contained herein, and same is submitted subject to errors omissions, change of price, rental or other conditions, withdrawal without notice, and to any specific listing conditions, imposed by our principals.

